

FSP Series

Active Heat Sink
with ATTACHMENT Holes

ALPHA

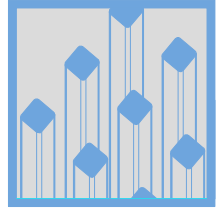

DIM

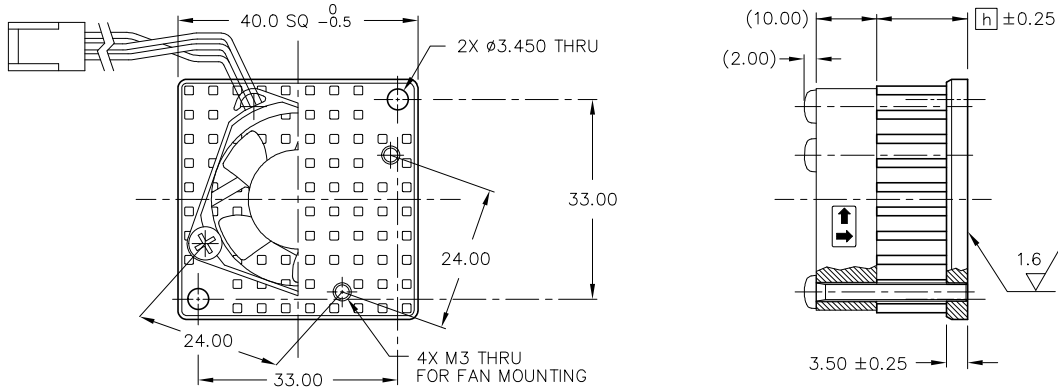

- HEAT SINK MATERIAL : A6063 FINISH : BLACK ANODIZE
- FAN M31: COFAN F-3010H12BIII 30 SQ +0.5/-0, 10 +0.5/-0 THK
- SCREW (Q'TY 3) PAN HEAD PHILLIPS M3 STEEL Cr3+
- FAN DETAIL: PLEASE VISIT OUR WEBSITE.

HEATSINK HEIGHT [h]	WEIGHT (grams)	MODEL	WEIGHT (grams)
8.00	16.4	FSP40-8M31	28.6
10.00	17.4	FSP40-10M31	29.8
12.00	18.3	FSP40-12M31	31.0
15.00	19.7	FSP40-15M31	32.8
20.00	22.0	FSP40-20M31	35.7
25.00	24.4	FSP40-25M31	38.7

■ TO SELECT PUSH PINS AND SPRINGS, TO APPLY TIM. PLEASE VISIT OUR WEBSITE.

DIMENSIONS : mm

DATA

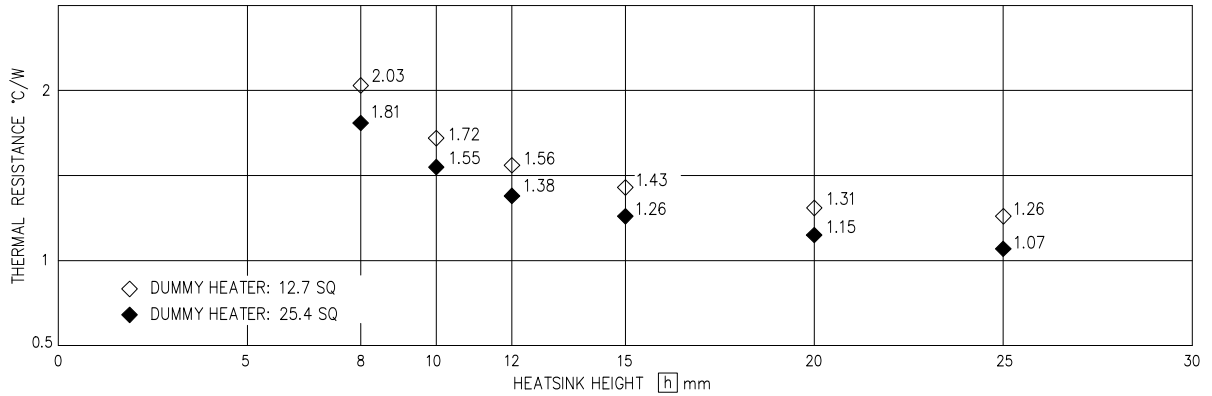

- TESTING SPECIFICATIONS, DUMMY HEATER SIZE : 12.7SQ & 25.4 SQ
- BASED ON ALPHA'S STANDARD TEST PROCEDURE. REFER TO TECHNICAL INFORMATION.

REF



PCB HOLE LAYOUT

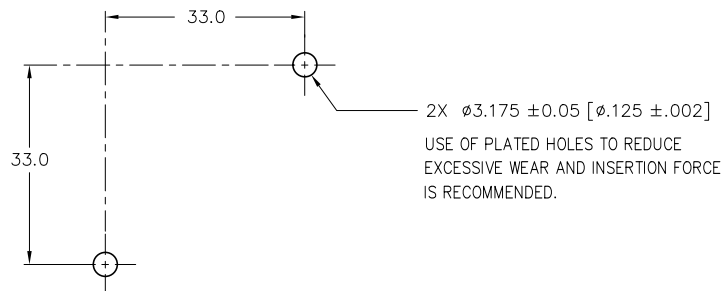

ALPHA

Active Heat Sink with Attachment Holes

FSP50

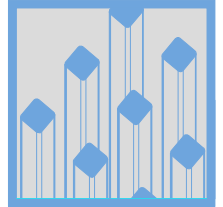

DIM

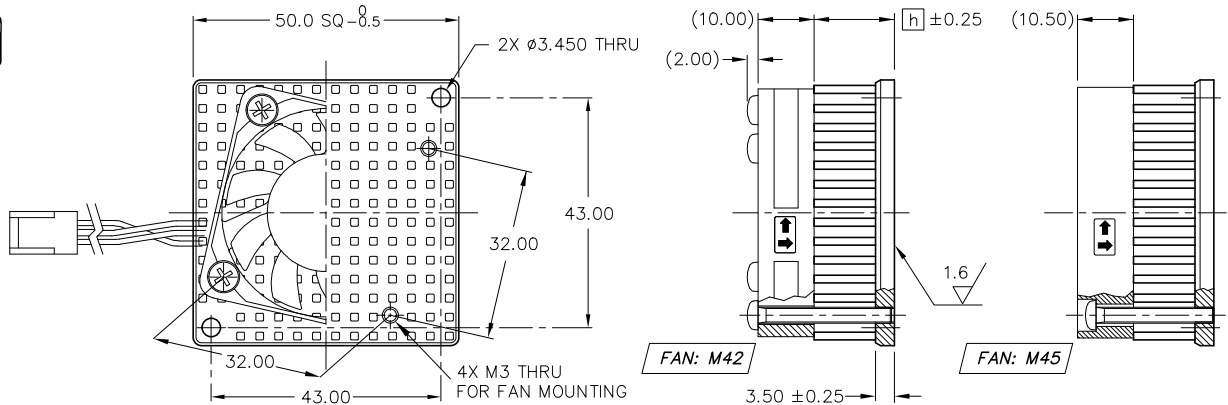

- HEAT SINK MATERIAL : A6063
FINISH : BLACK ANODIZE
- FAN M42: SANYO DENKI 109P0412H901
40 SQ +1/-0, 10 +1/-0 THK
M45: COFAN F-4010H12BII-12
40.5 SQ ±0.4, 10.5 ±0.2 mm THK
- SCREW (Q'TY 4) PAN HEAD PHILLIPS M3 STEEL Cr3+
- FAN DETAIL: PLEASE VISIT OUR WEBSITE.

HEATSINK HEIGHT [h]	WEIGHT (grams)	M42 FAN MODEL	WEIGHT (grams)	M45 FAN MODEL	WEIGHT (grams)
8.00	27.3	FSP50-8M42	51.5	FSP50-8M45	45.3
10.00	29.4	FSP50-10M42	53.9	FSP50-10M45	47.7
12.00	31.4	FSP50-12M42	56.3	FSP50-12M45	50.1
15.00	34.5	FSP50-15M42	59.9	FSP50-15M45	53.7
20.00	39.6	FSP50-20M42	65.8	FSP50-20M45	59.6
25.00	44.7	FSP50-25M42	71.7	FSP50-25M45	65.5

■ TO SELECT PUSH PINS AND SPRINGS, TO APPLY TIM. PLEASE VISIT OUR WEBSITE.

DIMENSIONS : mm

DATA

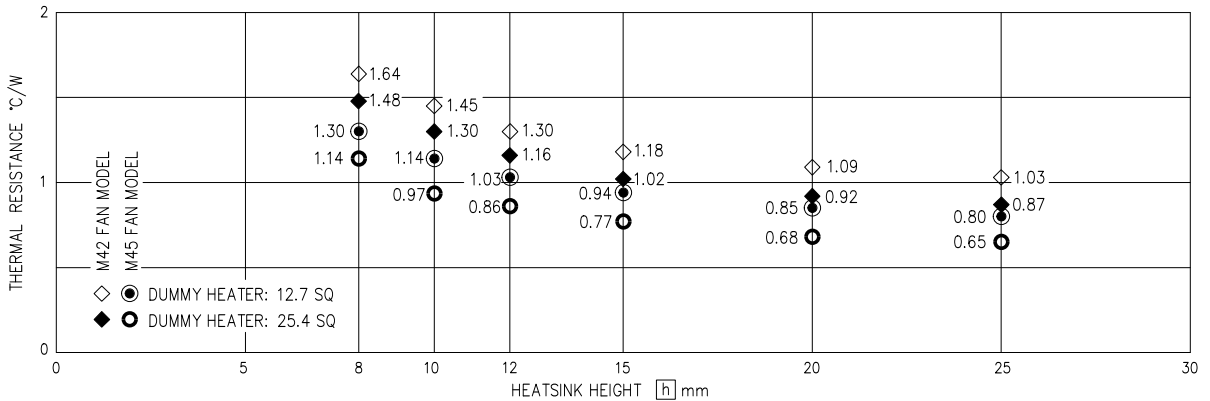

■ TESTING SPECIFICATIONS, DUMMY HEATER SIZE : 12.7SQ & 25.4 SQ
■ BASED ON ALPHA'S STANDARD TEST PROCEDURE. REFER TO TECHNICAL INFORMATION.

REF



PCB HOLE LAYOUT

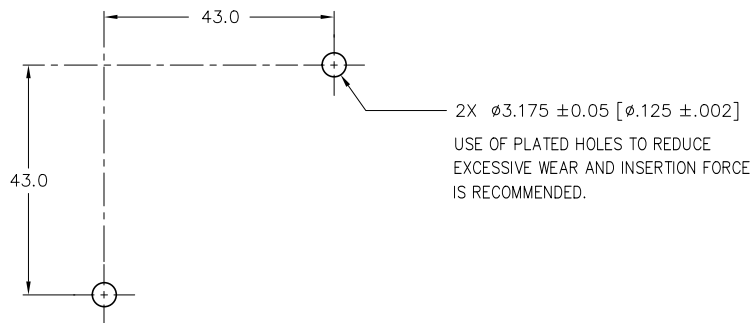

ALPHA

Active Heat Sink with Attachment Holes

FSP60

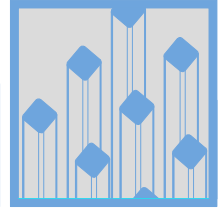

DIM

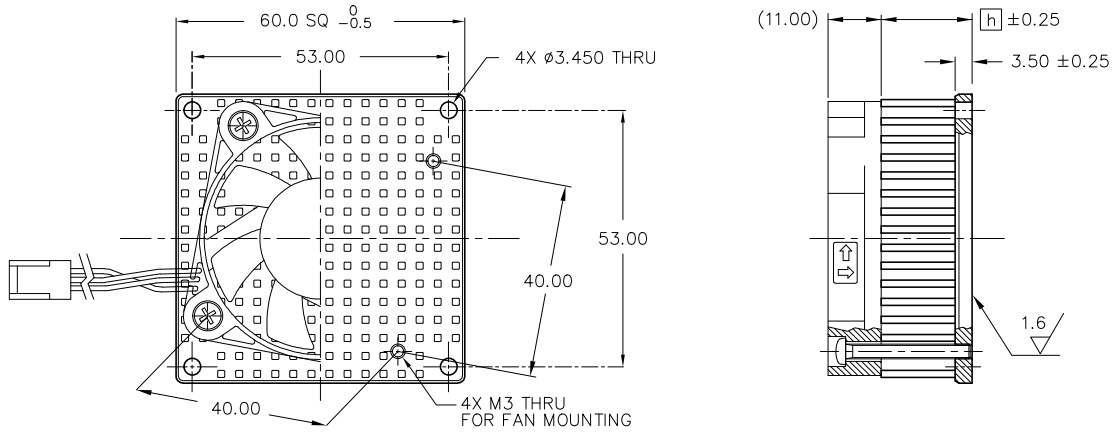

- HEAT SINK MATERIAL : A6063 FINISH : BLACK ANODIZE
- FAN M51: COFAN F-5010HH12B-11 50 SQ ±0.4, 11 ±0.3 mm THK
- SCREW (Q'TY 4) PAN HEAD PHILLIPS M3 STEEL Cr3+
- FAN DETAIL: PLEASE VISIT OUR WEBSITE.

HEATSINK HEIGHT [h]	WEIGHT (grams)	MODEL	WEIGHT (grams)
8.00	38.7	FSP60-8M51	62.6
10.00	41.3	FSP60-10M51	65.6
12.00	43.9	FSP60-12M51	68.5
15.00	47.9	FSP60-15M51	73.0
20.00	54.4	FSP60-20M51	80.3
25.00	61.0	FSP60-25M51	87.7

■ TO SELECT PUSH PINS AND SPRINGS, TO APPLY TIM. PLEASE VISIT OUR WEBSITE.

DIMENSIONS : mm

DATA

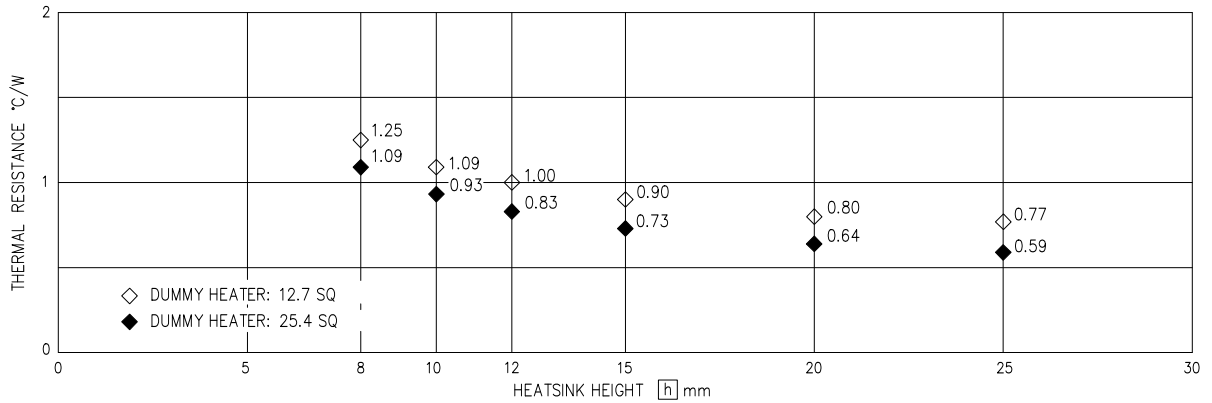

- TESTING SPECIFICATIONS, DUMMY HEATER SIZE : 12.7SQ & 25.4 SQ
- BASED ON ALPHA'S STANDARD TEST PROCEDURE. REFER TO TECHNICAL INFORMATION.

REF



PCB HOLE LAYOUT

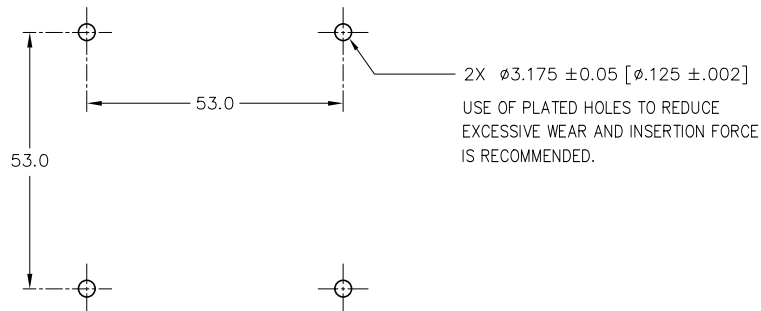

Alpha Company Ltd.

256-1 UEDA, NUMAZU-CITY SHIZUOKA-PREF., JAPAN
 PHONE +81(55)966 0789
 FAX +81(55)966 9192
 E mail : alpha@micforg.co.jp
 URL : https://www.micforg.co.jp

Alpha Novatech, Inc. - a subsidiary of Alpha Company.

473 Sapena Ct. #12 Santa Clara, CA 95054 USA
 PHONE +1(408)567-8082
 FAX +1(408)567-8053
 E mail : sales@alphanovatech.com
 URL : https://www.alphanovatech.com