

| REVISIONS | | | | |
|-----------|--------------|---|-------|-------|
| REV | DATE | DESCRIPTION | CHG | APPR |
| | JAN. 07, '16 | CHANGE PART NAME FROM SS-13.7(4.78-M3-5.8) | T. Y. | T. Y. |
| | JUL. 13, '17 | REMOVE DIMENSION OF UNDERCUTS-LENGTH FOR THREAD(WAS 1.00) | A. K. | A.K |

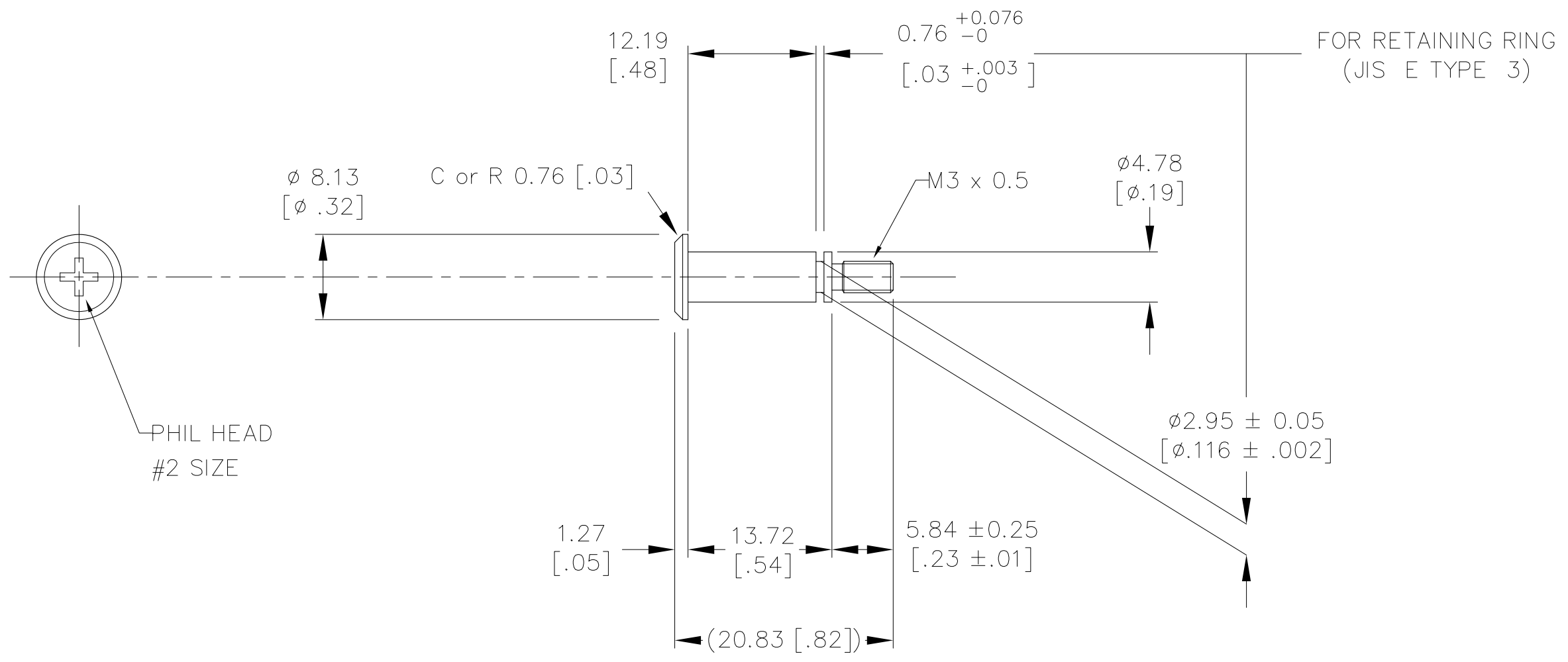

- NOTES : UNLESS OTHERWISE SPECIFIED
1. INTERPRET DIMENSIONS AND TOLERANCES PER ANSI Y14.5M-1982
 2. ALL DIMENSIONS ARE IN MILLIMETERS.
 3. MATERIAL
CARBON STEEL SWCH12A or EQUIVAIENT
ZINC /CLEAR CHROMATE (Cr3+)
 4. TOLERANCES :
.X ±0.254
.XX ±0.127
 6. BREAK AND DEBUR ALL SHARP EDGES
 7. UNSPECIFIED RADII: 0.5 MAX
 8. MACHINED SURFACE FINISH TO BE $\sqrt{6.3}$ OR BETTER.

| ITEM | PART NO. | PART NAME | REMARK | Q'TY |
|-----------------------|----------|----------------------|-----------------------------|-------|
| ALPHA CO.,LTD. | | | CSTM'R'S PART NO. | |
| | | MATERIAL NOTE 3 | NAME SS-13.7-4.8-M3-5.8 | |
| SCALE 2 : 1 | | APPR & CHCK Y.SUZUKI | PART NO. & DWG NO. S089HX1L | REV |
| DATE JAN 16 2015 | | DSGN & DWG Y.SUZUKI | RDCTN: | LOFF: |